

Heat - Shrinkable Joints

ECD1 heat-shrinkable cross-linked end caps with mastic, for double symmetric pipes

See 7.6 for further informations.

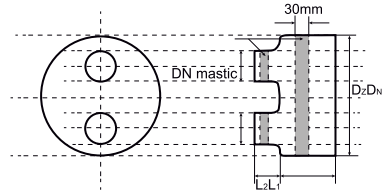

Jacket pipe external diameter Dz: (mm)	Shrinkage on the jacket pipe max / min Dwmax / Dwmin (mm)	Shrinkage on the steel pipe external max / min Dwmax / Dwmin (mm)	APPLICATION		Biosteel part no.
			Jacket / steel pipe Dz / 2 x DN: (mm)	s : (mm)	
125	133/95	32/22	125/2x20	18	ECD1-125/20+20
140	150/110	32/22	140/2x20	18	ECD1-140/20+20
140	150/110	38/27	140/2x25	18	ECD1-140/25+25
160	170/120	28/27	160/2x25	18	ECD1-160/25+25
160	170/120	48/34	160/2x32	18	ECD1-160/32+32
160	170/120	54/39	160/2x40	18	ECD1-160/40+40
180	190/130	48/34	180/2 x32	18	ECD1-180/32+32
180	190/130	54/39	180/2x40	18	ECD1-180/40+40
200	209/140	70/47	200/2x50	20	ECD1-200/50+50
225	234/180	70/47	225/2x50	20	ECD1-225/50+50
225	234/180	82/58	225/2x65	20	ECD1-225/65+65
250	260/195	82/58	250/2x65	20	ECD1-250/65+65
250	260/195	96/78	250/2x80	25	ECD1-250/80+80
280	290/215	96/78	280/2x80	25	ECD1-280/80+80
315	328/240	124/98	315/2x100	25	ECD1-315/100+100
355	370/260	124/98	355/2x100	25	ECD1-355/100+100
400	415/310	149/125	400/2x125	30	ECD1-400/125+125
450	465/390	149/125	450/2x125	30	ECD1-450/125+125
450	465/390	182/148	500/2x150	40	ECD1-450/125+125
500	520/465	182/148	500/2x150	40	ECD1-500/150+150
560	575/480	238/179	560/2x200	45	ECD1-560/200+200
630	655/530	238/179	630/2x200	45	ECD1-630/200+200

biosteel a/s

Algade 35, Grønbjerg · DK-6971 Spjald, Denmark
+45 4027 8099 · info@biosteel.dk · www.biosteel.dk